

NOTES: UNLESS OTHERWISE SPECIFIED

1. SEE DRAWING NO. CB-00295 AND PROCEDURE P-1000 FOR ASSEMBLY AND TEST INSTRUCTION. PROCEDURES AND ASSEMBLY DRAWINGS ARE FOR INTERNAL USE ONLY.
2. ALL TESTING ARE IAW BATTERY COUNCIL INTERNATIONAL STANDARDS.
3. ALL DIMENSIONS ARE IN INCHES [MM].
4. ABBREVIATION USED IN TITLE IS: SEALED LEAD ACID (SLA).

REVISIONS			
REV	DESCRIPTION	DATE	APPROVED
A	REDESIGNED CONTAINER, COVER	4/2/02	JBT
B	1.13 WAS 1.05	2/19/04	JBT

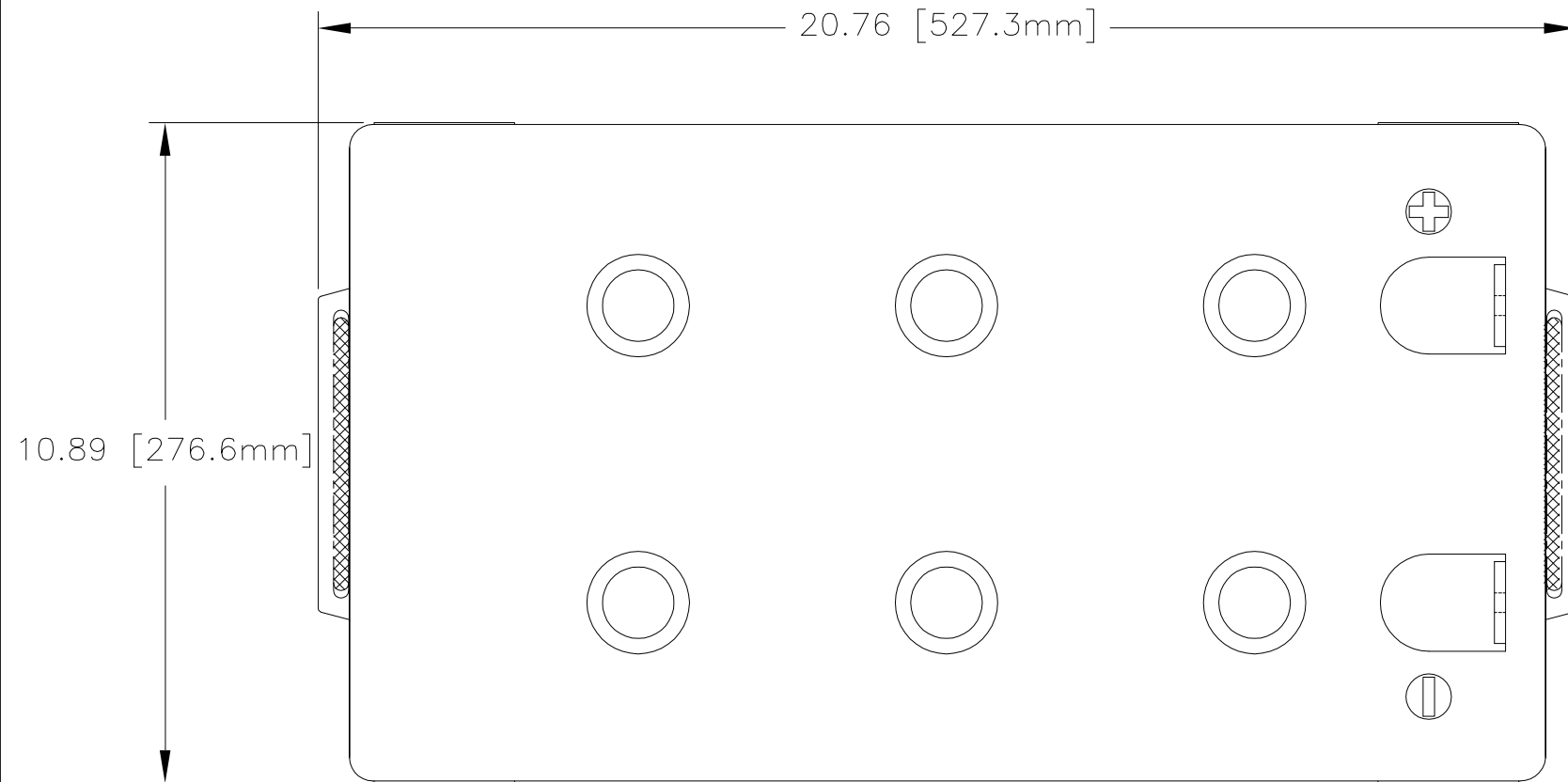

NOTE: SEE OPTIONS LISTED

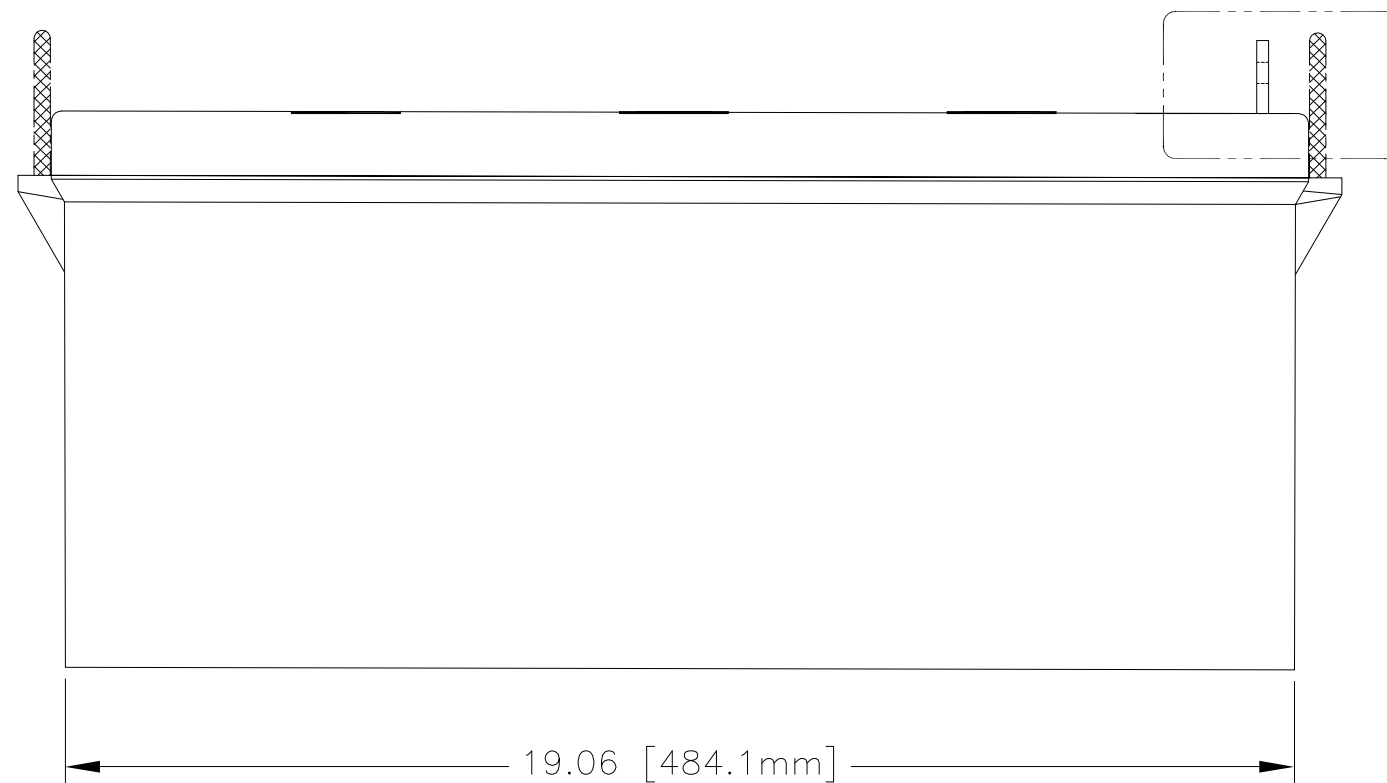

PVX-2580 TERMINAL OPTIONS

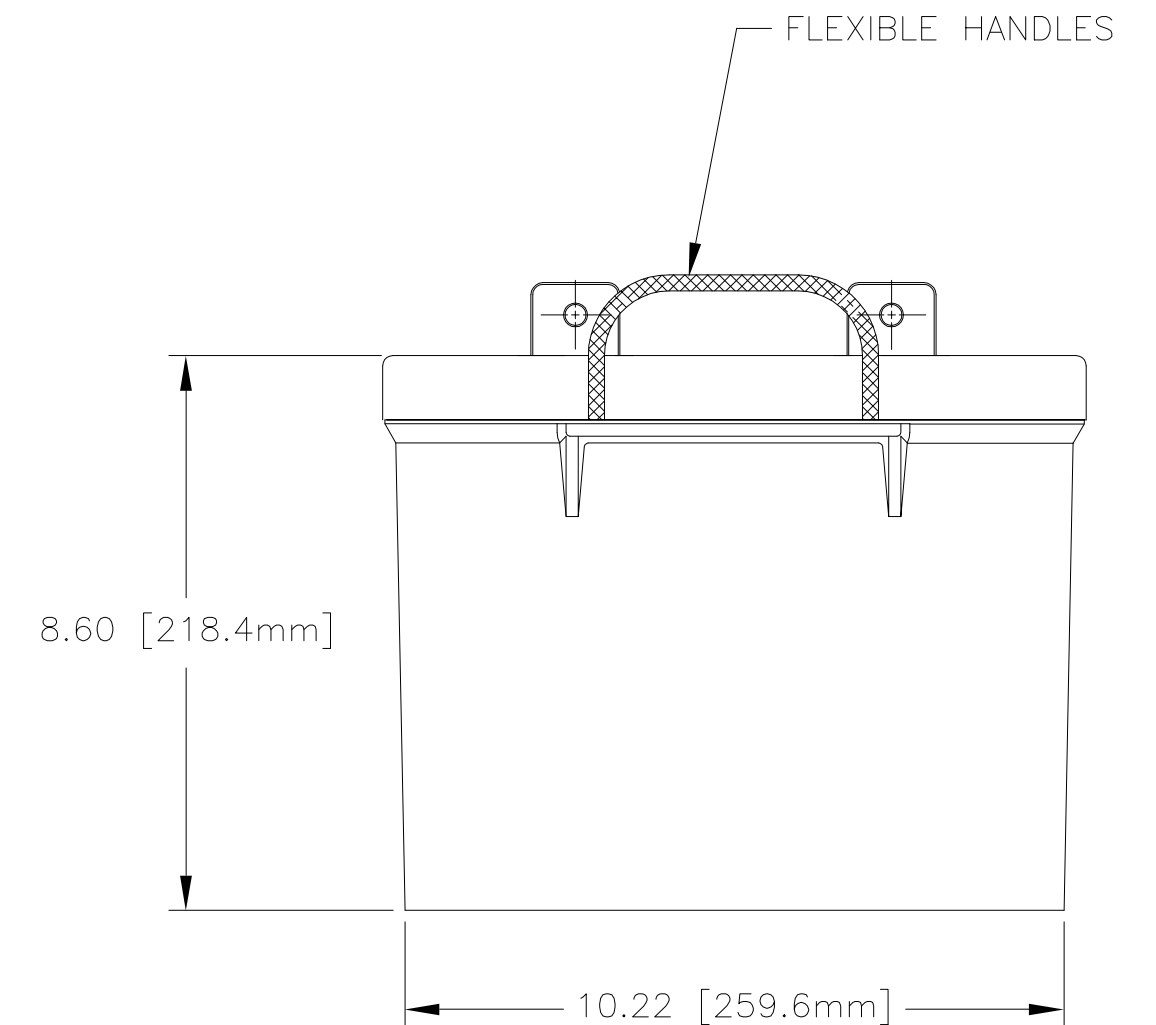
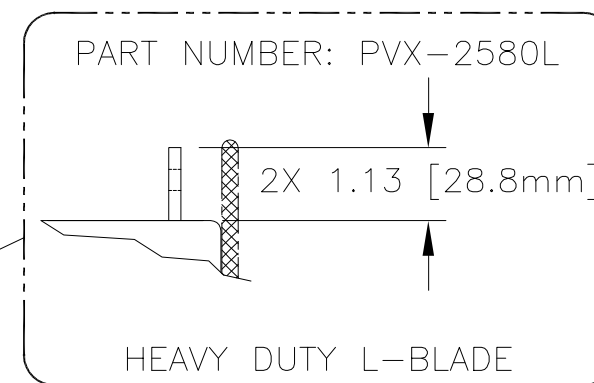

CAPACITY RATINGS	
PART NUMBER	PVX-2580
NOMINAL WEIGHT	165 LBS[75 KG]
AMPERE HOUR CAPACITY @ 24 HOUR 1.75 VOLTS/CELL @ 77°F (25° C)	258 AH

ENVELOPE DRAWING

QTY REQD	CAGE CODE	PART OR IDENTIFYING NO.	NOMENCLATURE OR DESCRIPTION	MATERIAL SPECIFICATION	ITEM NO.
PARTS LIST					
UNLESS OTHERWISE SPECIFIED DIMENSIONS ARE IN INCHES TOLERANCES ARE: FRACTIONS DECIMALS ANGLES ± 1/32 .XX ± .06 ± 1° .XXX ± .030			CONTRACT NO. NA		CONCORDE BATTERY CORPORATION 2099 SAN BERNARDINO RD, W. COVINA, CA 91790
TREATMENT NONE			APPROVALS	DATE	TITLE
FINISH NONE			DRAWN ELH	8/13/01	BATTERY, SLA, 12 VOLT, PVX-2580
SIMILAR TO NA			CHECKED HRF	8/21/01	SIZE C CAGE CODE 63017
ACT WT NA			APPROVED JBT	8/23/01	DWG NO. PVX-2580
CALC WT NA			ISSUED AT	3/2/04	REV B
SCALE NONE				SHEET 1 OF 1	