



## Universal Top-of-Pole Mounts

Single Pole PV Mounting System



 COMMUNICATIONS  ENERGY  SPECIAL INDUSTRIES  SOLAR



Quality Hardware for the PV Industry



# POWER-FAB® Universal Top-of-Pole PV Mounting (UTPM) System

## Key Benefits

- Maximum Strength
- Universal Design – Mounts most 60 cell modules
- Ease of Assembly – Reduced Parts
- Single Ground Penetration
- Seasonal Tilt Angle Adjustment

The POWER-FAB UTPM is designed to install quickly and provide a secure mounting structure for PV modules on a single pole. The universal design adapts to various 60 cell PV modules and provides for an easy assembly. The UTPM utilizes high strength welded steel

components and corrosion resistant hardware for long term reliability. Seasonal adjustability for maximizing electrical production is provided by six different tilt-angle settings and is a single person operation.

## Maximum Strength – Durable Design

- Standard design withstands 90 MPH wind zones
- Welded steel Strongbacks and mounting sleeves, powder coat finish
- 6000 series structural aluminum mounting rails, mill finish
- Stainless Steel module mounting hardware

## Application Flexibility

- Several UTPM sizes available to mount 4 through 15 modules
- Secures most 37 - 42" wide by 61 - 67" long PV modules
- Installs over standard Schedule 40 or 80 rigid steel pipe (Installer Supplied)
- 15° to 65° tilt angle settings (10° increments)
- Mount up to 4 kW on a single pole

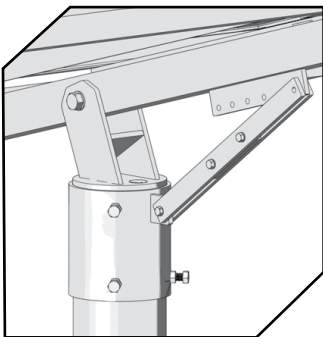

## Main Structural Components

- |                   |                           |
|-------------------|---------------------------|
| 1 Module Rails    | 5 Double Hole Slide Plate |
| 2 Cross-Bars      | 6 Single Hole Slide Plate |
| 3 Support Bar     | 7 Strongback              |
| 4 Mounting Sleeve |                           |

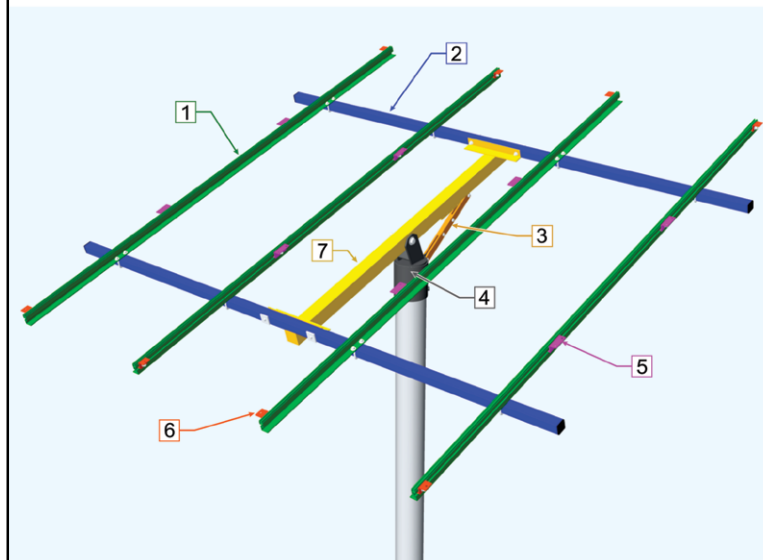

4000 Vassar Drive NE  
Albuquerque, New Mexico 87107  
USA

Telephone: 800.260.3792  
Fax: 505.889.3548  
Web Site: [www.dpwsolar.com](http://www.dpwsolar.com)  
E-mail: [info@power-fab.com](mailto:info@power-fab.com)

© 2014 Preformed Line Products  
Printed in U.S.A.  
SL-SS-1029  
05.14.1M

## Ease of Assembly – Reduced Labor Costs

- Slide plates provide easy adjustment
- Compatible with WEEB bonding washers
- Double hole plate aligns module spacing
- Easy access bottom flange bolting

## Ordering Guideline

**UTPM8-G**



DPW Module Series  
Number of Modules  
Options: 4, 6, 8, 10, 12, 14, and 15

*Foundation Design Support available from DPW Solar's staff of engineers.*